

# HOW TO ASSY OF SCS2 AND SCS5

**(STEP1)**  
Thread CORD through CASE.

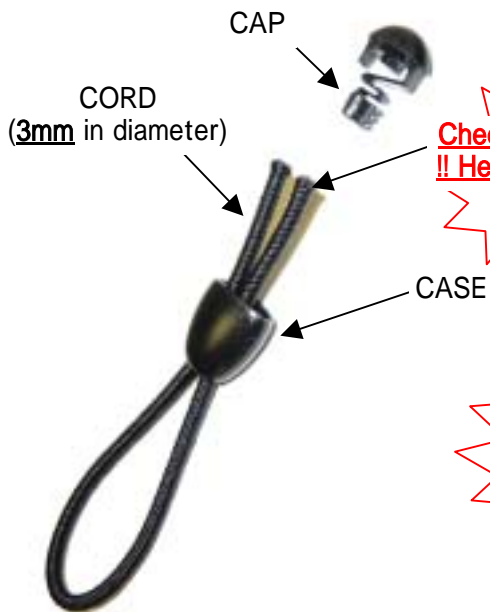

<pic-A> part structure

**(STEP2)**  
Set CORD with CAP.

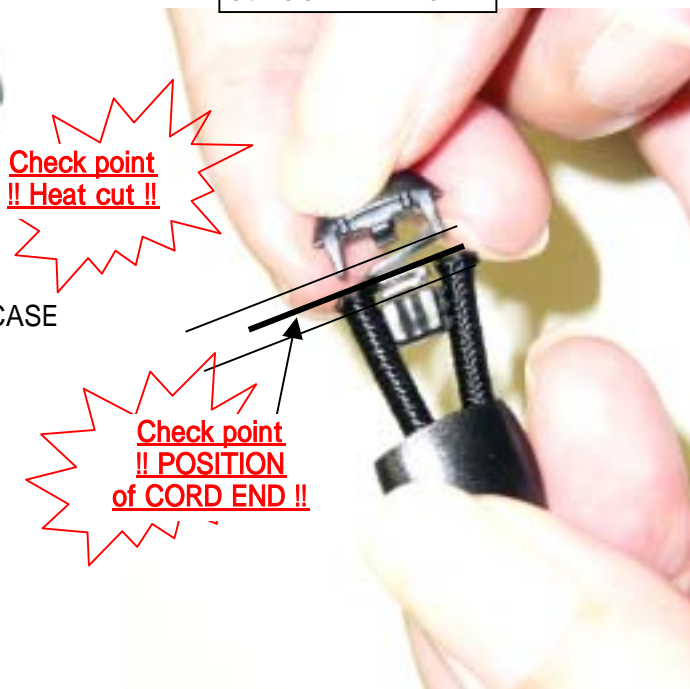

<pic-B> CORD assy state

**(STEP3)**  
Make SUB ASSY STATE.  
Set CAP with CORD in CASE.



<pic-C> SUB ASSY STATE

# HOW TO ASSY OF SCS2 AND SCS5

**(STEP4)**  
Make PUSH STATE.  
Pull CORD with CAP into CASE.



<pic-D> CAP set assy state

**(STEP5)**  
Make COMPLETION STATE.  
Push CAP into CASE to lock.

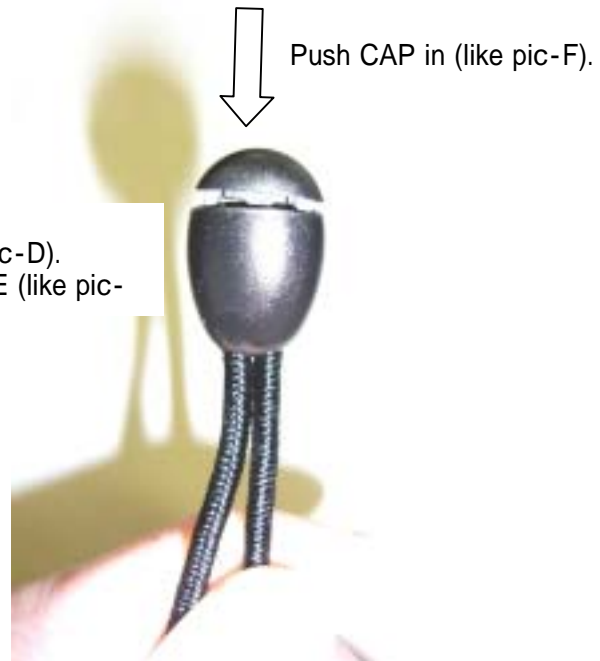

<pic-E> PUSH state

**(STEP6)**  
Check COMPLETION STATE.

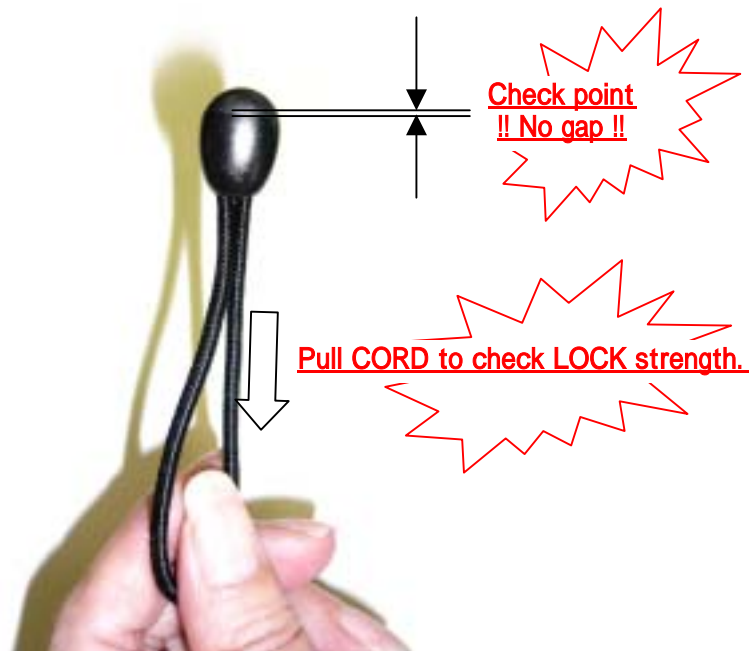

<pic-F> COMPLETION STATE