

NIFCO LX series Speeding lace lock – Assembly instruction

A. Check the direction

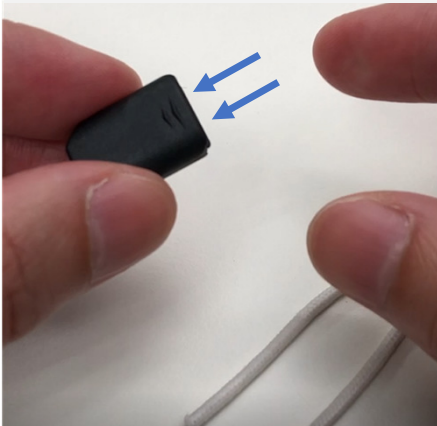

B. Insert the lace

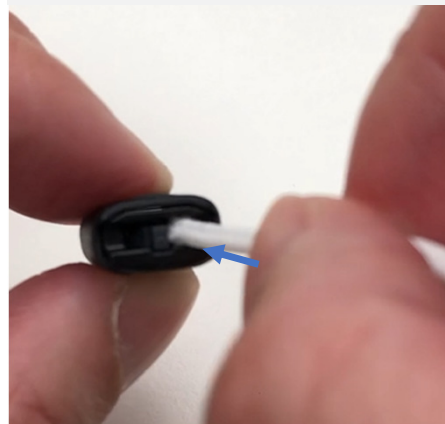

C. Push through

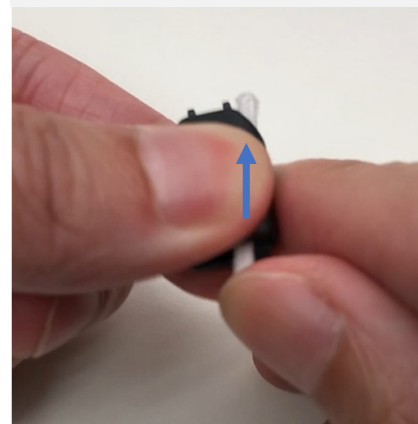

D. Pull the lace out

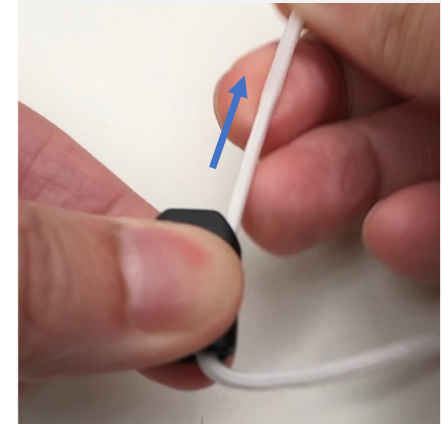

E. Repeat the steps for the other lace

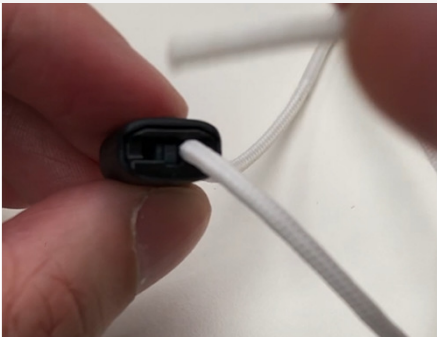

F. Completed



NIFCO LX series

Speeding lace lock – Assembly instruction

Direction of lace lock

- Grip mark shows the front side



Lace type recommendation

- Round type with solid tip

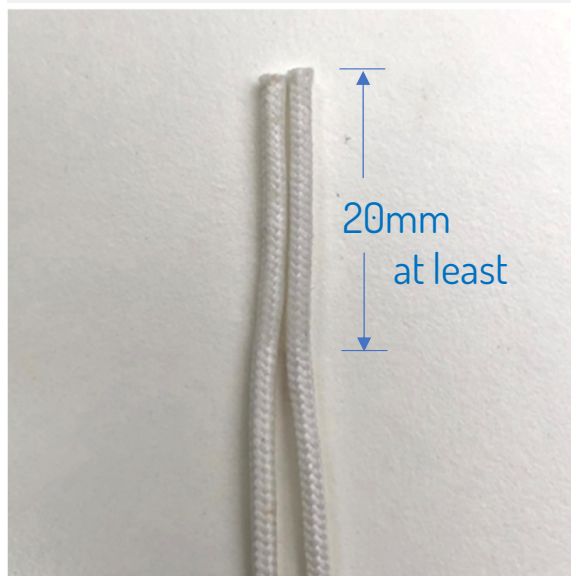

Lace lock assembled direction

- Lace assembled from top side

